

CORNER RECORD

City of BERKELEY
CITY OF BERKELEY MONUMENT B0228
Brief Legal Description _____

Document Number CR 6642
County of ALAMEDA, California

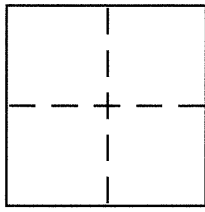

CORNER TYPE
Government Corner ☐ Control ☐
Meander ☐ Property ☐
Rancho ☐ Other ☐
Date of Survey JULY 28, 2014

COORDINATES (Optional)
N. _____
E. _____
Zone _____ NAD27 ☐ NAD83 ☐
NAD83 Epoch _____
Elev. _____
Vert. Datum: NGVD29 ☐ NAVD88 ☐
Meas. Units: Metric ☐ Imperial ☐

Corner - Left as found ☐ Found and tagged ☐ Established ☐ Reestablished ☐ Rebuilt ☐

Identification and type of corner found: Evidence used to identify or procedure used to establish or reestablish the corner:
**IN COMPLIANCE WITH SECTION 8771 OF THE PROFESSIONAL LAND SURVEYORS' ACT, THIS CORNER
RECORD IS BEING FILED TO PLACE A CITY SURVEY MONUMENT AT THE LOCATION SHOWN ON PAGE 2.**

A description of the physical condition of the monument as found and as set or reset: _____
SEE PAGE 2

SURVEYOR'S STATEMENT

This Corner Record was prepared by me or under my direction in conformance with
the Land Surveyor's Act on JULY 30, 2014
Signed [Signature] P.L.S. or R.C.E. No. 5003

COUNTY SURVEYOR'S STATEMENT

This Corner Record was received 9-18-14
and examined and filed 9-25-14
Signed [Signature] P.L.S. or R.C.E. No. 5726
Title COUNTY SURVEYOR

County Surveyor's Comment _____

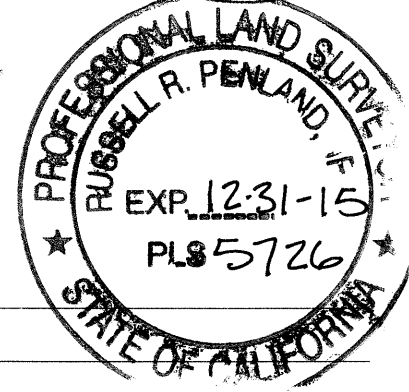

UY12C7

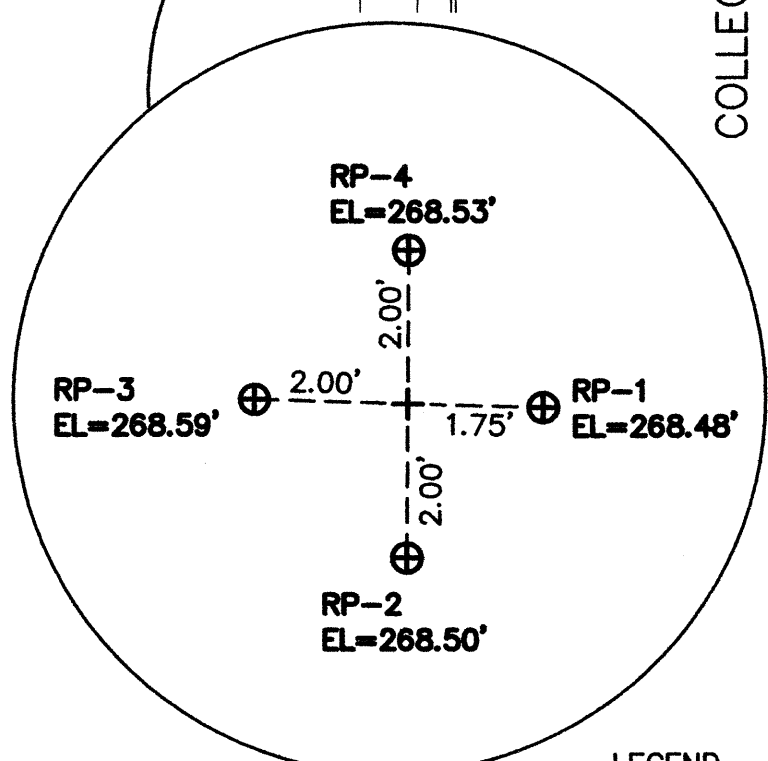
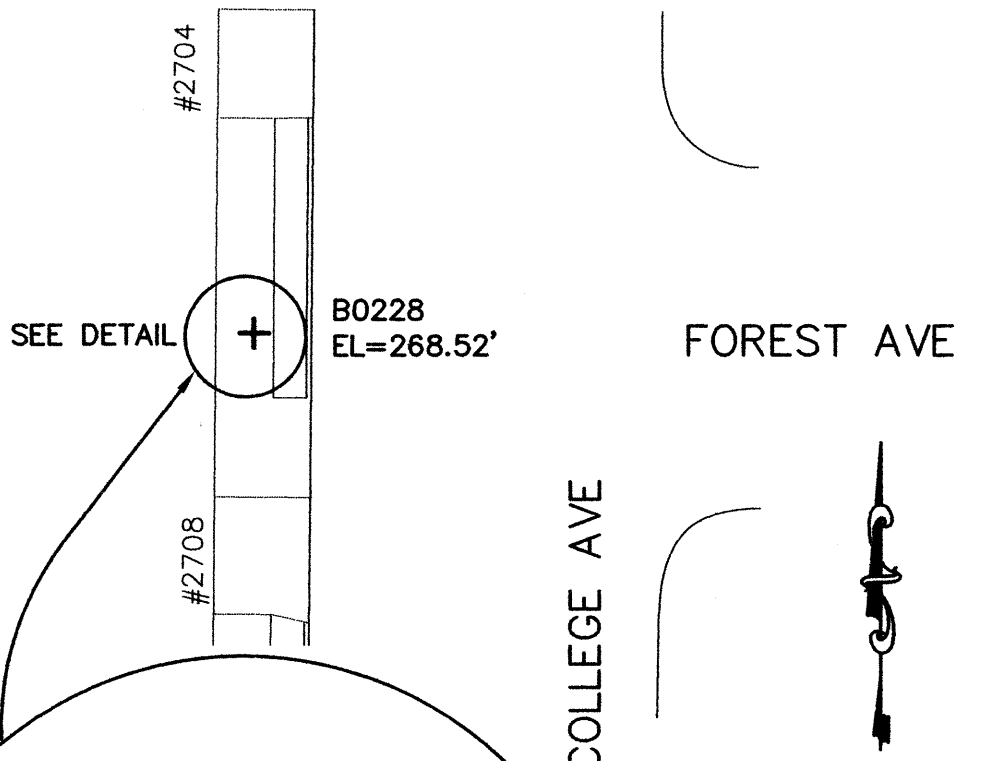

DETAIL

LEGEND

- ⊕ FOUND CITY MONUMENT
CROSS B0228
- ⊕ SET REFERENCE CROSS

NOTE:

THE EXISTING MONUMENT AS SHOWN
IS REFERENCED BY STRAIGHT LINES
BETWEEN RP-1 TO RP-3 AND RP-2
TO RP-4.