

Township N^o 2 North, Range N^o 2 East, Mount Diablo Meridian.

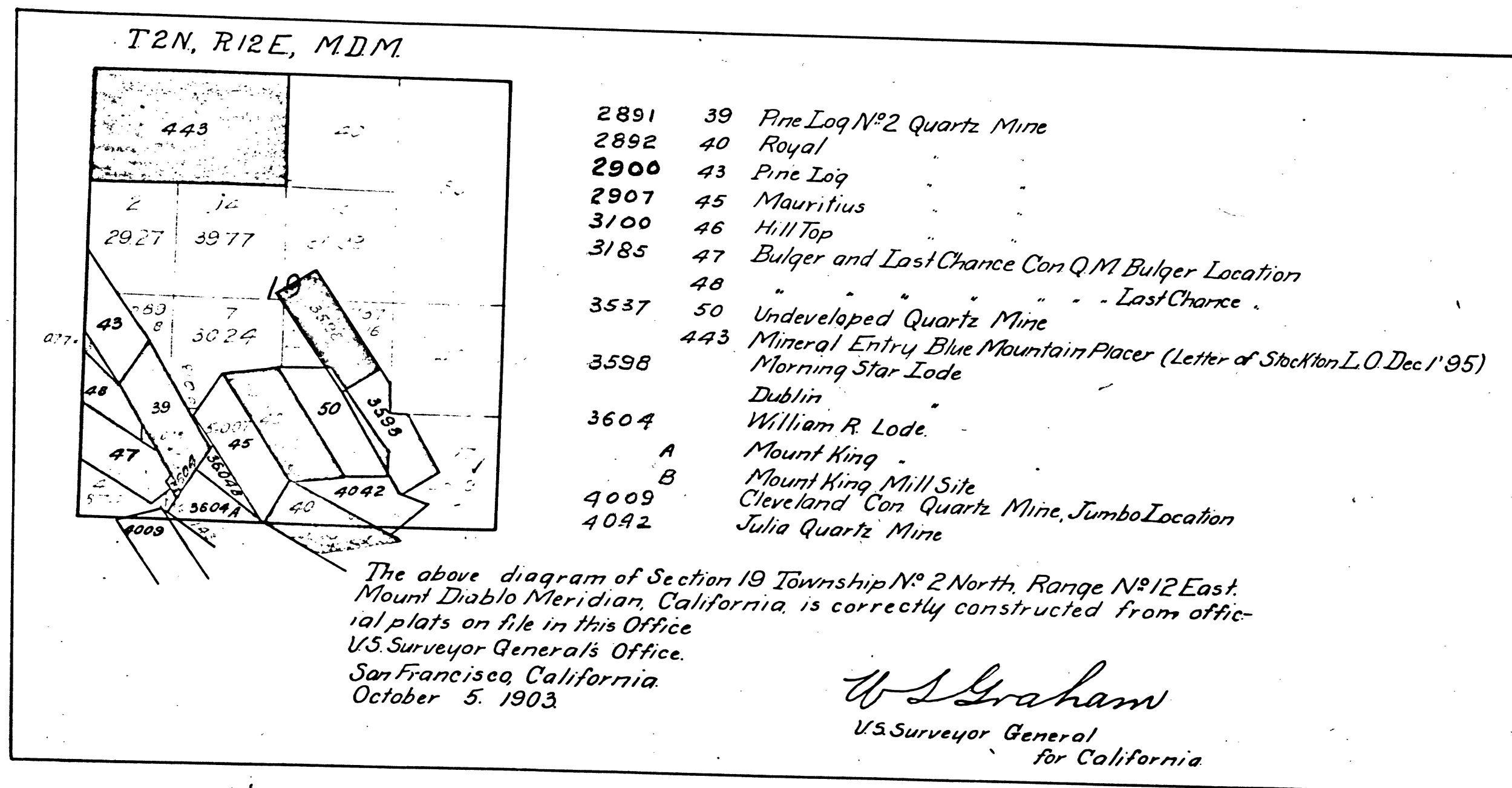
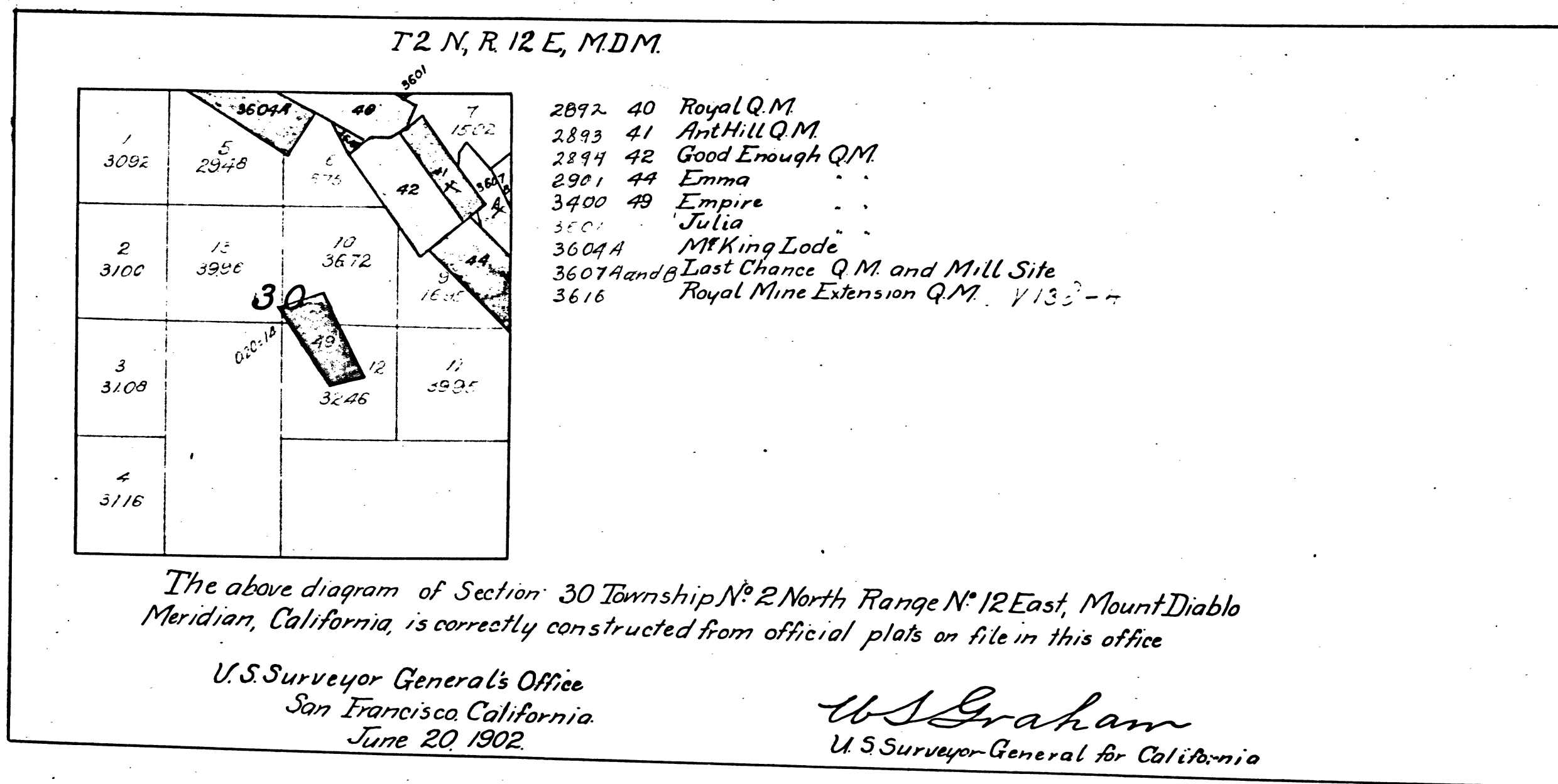

DEPARTMENT OF THE INTERIOR,
GENERAL LAND OFFICE,
Washington, D. C. Dec. 14 1907.
I hereby certify that this is a true copy
of the plats of official survey of the lands
to which it relates, on file in this office.

H. H. Langford,
Recorder, General Land Office.

41 107

3

T 2 N R 12 E M D

BLM 24

