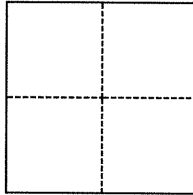

CORNER RECORD

BK 101 PG 5

Agency Index

Document Number CR 10545

City of Berkeley County of Alameda, CaliforniaBrief Legal Description Monument Ties, Cragmont Ave at Lot 15 (23 M 84)**CORNER TYPE**

- ☐ Government Corner ☐ Control
☐ Meander ☐ Property
☐ Rancho ☒ Other

Date of Survey _____

COORDINATES (Optional)

N. _____ E. _____

Elevation _____

Units ☐ Metric ☐ U.S. Survey Foot

Horizontal Datum _____

Zone _____ Epoch Date _____

Vertical Datum _____

☐ Complies with Public Resources Code §§8801-8819☐ Complies with Public Resources Code §§8890-8902PLS Act Ref.: ☐ 8765(d) ☐ 8771 ☐ 8773 ☒ Other:

Corner/
Monument: ☐ Left as found ☐ Established ☐ Rebuilt ☒ Pre-Construction
☐ Found and tagged ☐ Reestablished ☐ Referenced ☐ Post-Construction

Narrative of corner identified and monument as found, set, reset, replaced, or removed:

☒ See sheet #2 for description(s):**SURVEYOR'S STATEMENT**

This Corner Record was prepared by me or under my direction in conformance with

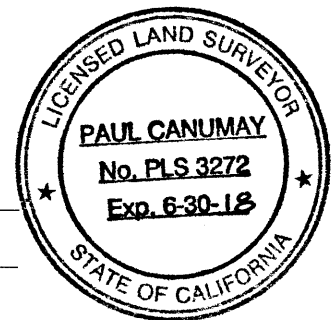
the Professional Land Surveyors' Act on August 1, 2017Signed Paul Canumay P.L.S. or R.C.E. No. 3272**COUNTY SURVEYOR'S STATEMENT**This Corner Record was received 23 AUGUST, 2017and examined and filed 1 SEPTEMBER, 2017Signed Michael Rubner P.L.S. or R.C.E. No. 6843Title COUNTY SURVEYOR

County Surveyor's Comment

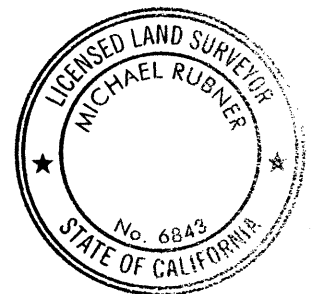

LOT 16

10' PATH

LOT 15
(23 M 84)

701 CRAGMONT AVE.

HALKIN
LANE

CRAGMONT AVE. (40' R/W)

N10°00'00"E

244.37' (M-M)

20'

AT LOT 10/11
LEGEND

● FOUND STD. STREET MONUMENT
X SET NAIL & TAG (PLS 3272)



SCALE: 1"=10'

