

STATE OF CALIFORNIA  
BUSINESS, TRANSPORTATION AND HOUSING AGENCY  
DEPARTMENT OF TRANSPORTATION

**RECORD OF SURVEY and MONUMENTATION MAP**  
**STATE HIGHWAY 101**

In Yokayo Rancho and

Sections 6, 7, 8, Township 16 North, Range 12 West, M.D.B. &M. and

Section 1, Township 16 North, Range 13 West, M.D.B. &M. and

Sections 26, 35, 36, Township 17 North, Range 13 West, M.D.B. &M.

COUNTY OF MENDOCINO

STATE OF CALIFORNIA

**LEGEND**

- CALCULATED POSITION FROM RECORD, NOTHING FOUND OR SET
- FOUND POINT AS NOTED
- ✕ FOUND 1" GALVANIZED IRON PIPE W/PLASTIC YELLOW CAP STAMPED "CALIF" AND "DOT"
- ✕ FOUND 1/2" GALVANIZED IRON PIPE W/PLASTIC PLUG STAMPED LS4205
- FOUND C.H.C. MONUMENT
- ▲ FOUND CONTROL STATION, SEE LIST FOR DESCRIPTION
- △ SET CONTROL STATION, SEE LIST FOR DESCRIPTION
- ⊙ NGS CONTROL STATION, SEE LIST FOR DESCRIPTION
- ◆ FOUND SECTION CORNER AS NOTED
- ▣ FOUND QUARTER CORNER AS NOTED
- θ MAPPING ANGLE
- ( ) RECORD
- [ ] RECORD & MEASURED
- O.R. OFFICIAL RECORDS
- N.T.S. NOT TO SCALE

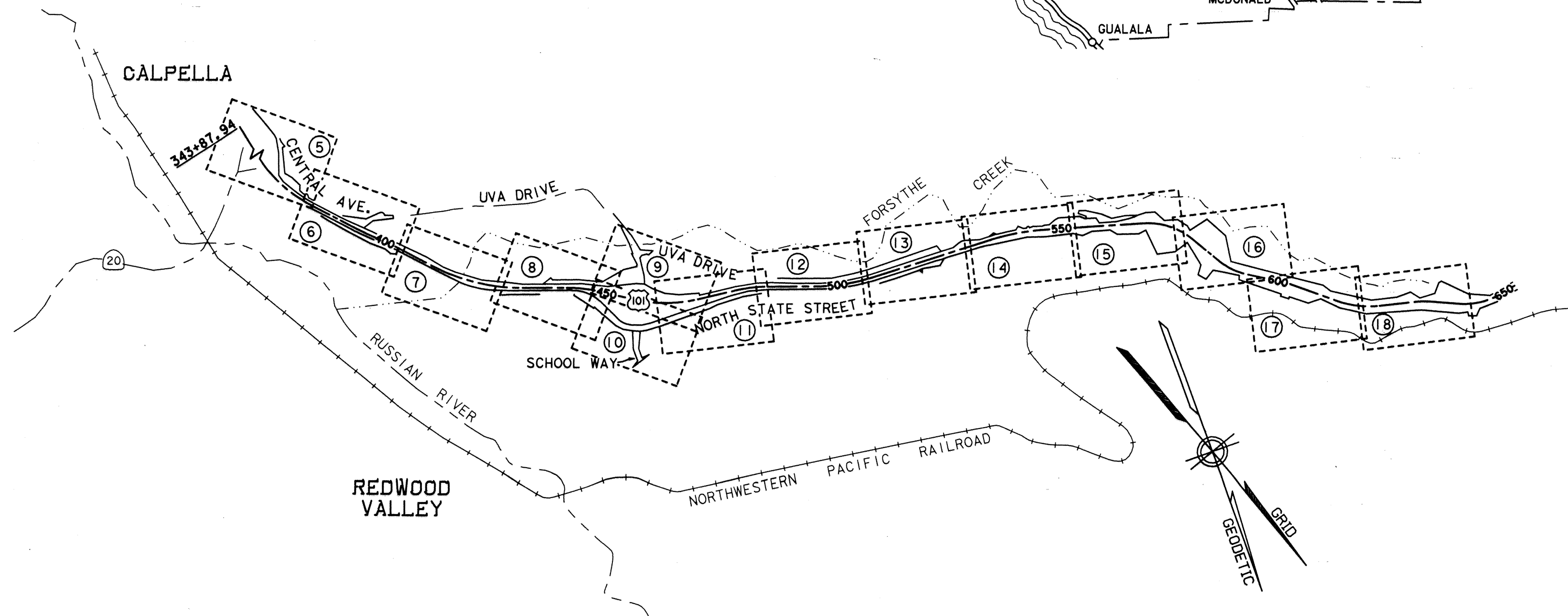

**LOCATION MAP**

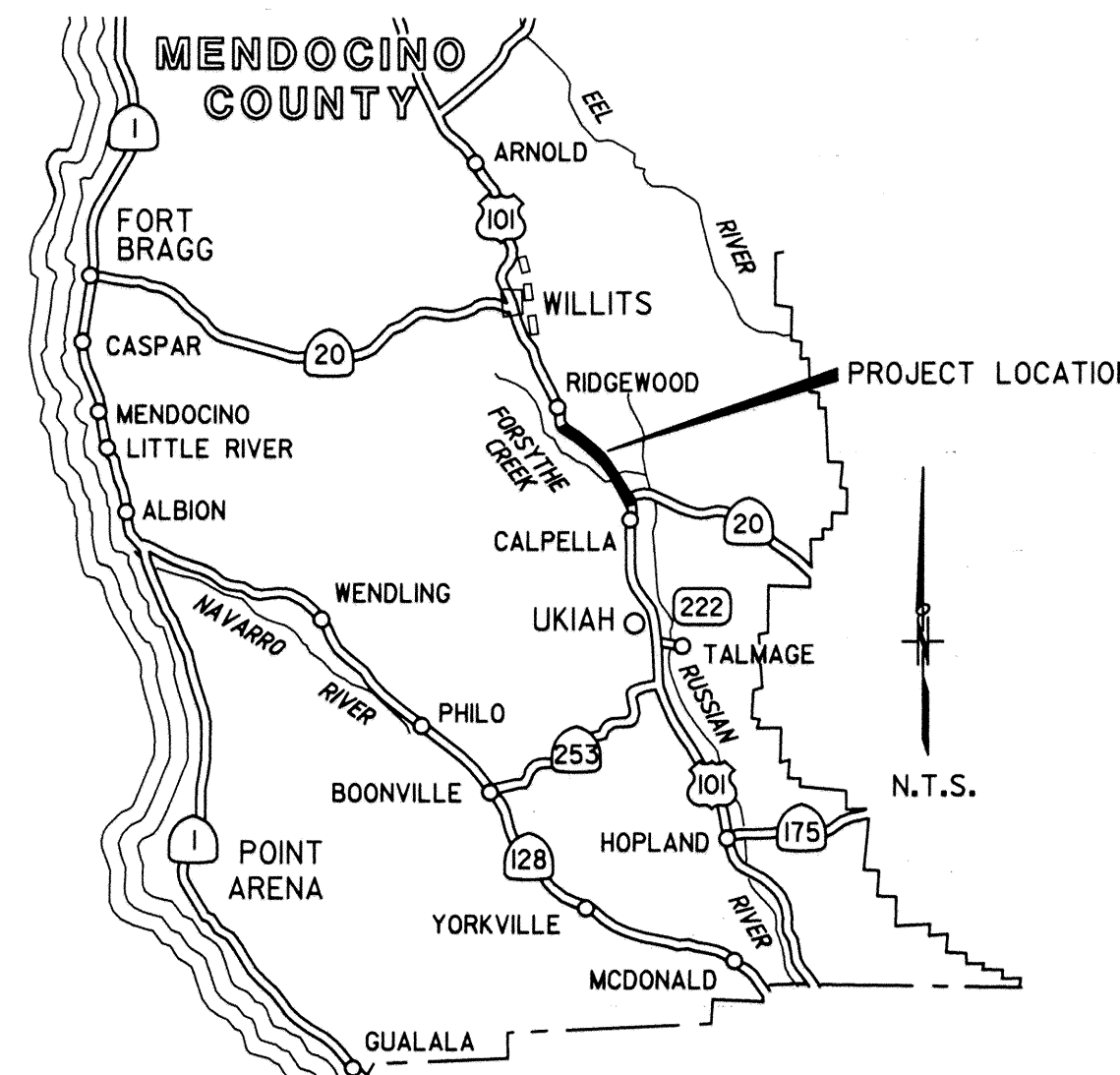

**SURVEYOR'S STATEMENT**

THIS MAP CORRECTLY REPRESENTS A SURVEY MADE BY ME OR UNDER MY DIRECTION  
IN CONFORMANCE WITH THE REQUIREMENTS OF THE LAND SURVEYORS' ACT AT THE  
REQUEST OF THE STATE OF CALIFORNIA, DEPARTMENT OF TRANSPORTATION - CALTRANS.



*Mike McCalligan*  
MIKE McCALLIGAN P.L.S. 6885  
LICENSE EXPIRATION DATE: 12-31-2004  
NORTH REGION OFFICE OF SURVEYORS

**COUNTY SURVEYOR'S STATEMENT**

THIS MAP HAS BEEN EXAMINED IN ACCORDANCE WITH SECTION 8766 OF THE LAND  
SURVEYORS' ACT THIS 2ND DAY OF AUGUST, 2002.

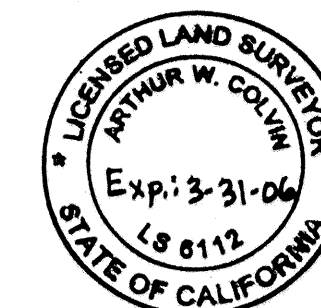

*Arthur W. Colvin*  
ARTHUR W. COLVIN L.S. 6112  
LICENSE EXPIRATION DATE: 03-31-2006  
MENDOCINO COUNTY SURVEYOR

**RECORDER'S STATEMENT**

FILED THIS 7 DAY OF AUGUST, 2002 AT 8:33 a.m.  
IN MAPS, DRAWER 69, PAGE 96, M.C.R., AT THE REQUEST OF CALTRANS

MARSHA A. WHARFF  
MENDOCINO COUNTY RECORDER

BY: *W. A. Bernard*  
DEPUTY COUNTY RECORDER

NO FEE REQUIRED PER GOVERNMENT CODE 6103

STATE OF CALIFORNIA  
BUSINESS, TRANSPORTATION AND HOUSING AGENCY  
DEPARTMENT OF TRANSPORTATION  
NORTH REGION  
OFFICE OF SURVEYORS

**RECORD OF SURVEY  
MONUMENTATION MAP**

STATE HIGHWAY 101

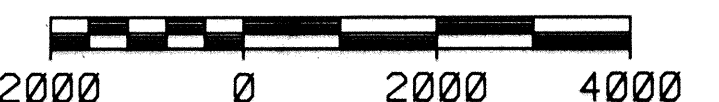

MAPS  
DRAWER 69  
PAGE 96

CO.	RTE.	P.M.	SHEET NUMBER
MEN	101	30.9/36.1	1 OF 18

ROS 19-02