

# LIGHTING FIXTURE SCHEDULE

PROVIDED FOR INFORMATION ONLY.  
VERIFY AND INSTALL PER ELECTRICAL DRAWING

01-11-19

ITEM	SYMBOL	DESCRIPTION	QTY.	WATTS	MFR. & CAT. NO.	REMARK
INTERIOR LIGHTING ITEM						
L1		T-BAR CEILING RECESSED MOUNTED LED LIGHTING FIXTURE, 2' X 4', 120V BAKED-ON WHITE ENAMEL FINISH.	REFER TO ELECTRICAL SHEET E-001 FOR LIGHTING FIXTURE QUANTITY		LSI FIXTURE: SFP24-LED-50-UE-DIM-35	KITCHEN CEILING LIGHTS, FURNISHED BY OWNER INSTALLED BY GC
L1B		T-BAR CEILING RECESSED MOUNTED LED LIGHTING FIXTURE, 2' X 2', 120V BAKED-ON WHITE ENAMEL FINISH.			LSI FIXTURE: SFP22-LED-30-UE-DIM-35-U	KITCHEN CEILING LIGHTS, FURNISHED BY OWNER INSTALLED BY GC
L1EM		T-BAR CEILING RECESSED MOUNTED LED LIGHTING EMERGENCY FIXTURE, 2' X 4', 120V BAKED-ON WHITE ENAMEL FINISH.			LSI FIXTURE: SFP24-LED-50-UE-DIM-EM	EMERGENCY KITCHEN CEILING LIGHTS FURNISHED BY OWNER INSTALLED BY GC
L4HO		UNIVERSAL MOUNT EXIT SIGN, LED LIGHTED, 120/277V WITH BATTERY PACK, 2 FACE, GREEN LETTER			EXITRONIX GXEX-U-BP-WB-BL-R6	EXIT SIGN FURNISHED BY OWNER, INSTALLED BY GC
L6A		HOOD LIGHT			FURNISHED & INSTALLED BY EQUIPMENT SUPPLIER	LIGHTS SUPPLIED & PRE-WIRED BY HOOD VENDOR, ELECTRIC CONTRACTOR TO CONNECT MAIN WIRES TO SHUNT TRIP BREAKER AND HOOD CONTROL PANEL
L6B		WALK-IN COOLER FLUORESCENT LIGHT, 120 V 48"			KASON FIXTURE: # 1810LX4000	FURNISHED BY WIC VENDOR, G.R.E., INSTALLED BY GC
L19		DOWN LIGHT, RECESSED IN CEILING			ELITE HOUSING: LD6C-AT LED MODULE: ELITE LED LIGHTING RL607-750L-DIMTR-120-30K-SN-SN-90+	FURNISHED BY OWNER, INSTALLED BY GC
L19EM		EMERGENCY DOWN LIGHT, RECESSED IN CEILING			ELITE HOUSING: LD6C-AT LED MODULE: ELITE LED LIGHTING RL607-750L-DIMTR-120-30K-SN-SN-90+	EMERGENCY RECESSED DOWN LIGHT - NORMALLY ON INVERTER UNIT - ISOLITE, IMI-12-LC-V1 FURNISHED BY OWNER INSTALLED BY GC
L20		3 3/4" ADJUSTABLE MR16 DOWN LIGHT, RECESSED IN CEILING			LIGHTOLIER: LYTECASTER-378WHX FRAME-IN KIT: 302MRSPX BULB: MR16 - GE - PRECISE IR 37 WATT 40° BEAM	FURNISHED BY OWNER, INSTALLED BY GC
L30		WHITE LED AT SERVICE COUNTER SOFFIT & DINING ROOM PARTIAL HEIGHT WALL			LUXEM BRIGHT FIXTURE: BLAZE LED	FURNISHED BY OWNER, INSTALLED BY GC
L43		12" DIA. DECORATIVE BAYLOR PENDANT LF INCANDESCENT	REFER TO ELECTRICAL SHEET E-001 FOR LIGHTING FIXTURE QUANTITY		LBL LIGHTING, MODEL # P146TORB BULB: LED EDISON LAMP, 1173467	FURNISHED BY OWNER, INSTALLED BY GC
L45		12" DIA. DECORATIVE MORILL PENDANT LF INCANDESCENT			LBL LIGHTING, MODEL # 6227801-839 BULB: LED EDISON LAMP, 1173467	FURNISHED BY OWNER, INSTALLED BY GC
L100		MICRO INVERTER			ISOLITE #IMI 125	FURNISHED BY OWNER, INSTALLED BY GC
S		SPEAKER			-	FURNISHED BY MUSIC VENDOR, INSTALLED BY MUSIC VENDOR
LF		FESTOON LIGHTING			LIGHTCRAFT OUTDOOR 55" BK-E26-S BK-LEAD 55" LED-BK-S14-1-120	FURNISHED BY OWNER, INSTALLED BY GC

## NIGHT LIGHTING REQUIREMENTS: "NL" DESIGNATION INDICATED NIGHT LIGHT ON UNSWITCHED CIRCUIT.

1. ONE NL BY SERVICE COUNTER, POS / CASHIER
2. ONE NL BY POS / CASHIER AT DRIVE THRU STATION IF APPLICABLE
3. ONE NL BY EACH EXIT DOORS IN DINNING ROOM & BACK OF HOUSE

## EXTERIOR LIGHTING

L40		LINEAR LIGHT AT EXTERIOR STORAGE ROOM	REFER TO ELECTRICAL SHEET E-001 FOR LIGHTING FIXTURE QUANTITY		COOPER MX-4VT2LD4-6-DR-JUNV-L840-CD1-WL-U	FURNISHED BY OWNER, INSTALLED BY GC
L65		WALL MOUNTED OVER SERVICE DOOR FIXTURE			HOWARD: VL305 30W LED, BRONZE	OVER EXTERIOR SERVICE DOOR. REFER ELEVATIONS FOR HEIGHT FURNISHED BY OWNER, INSTALLED BY GC
L66		NAVILITE EMERGENCY LIGHT			EXITRONIX MLED1-G-WP	OVER EXTERIOR ENTRANCE & SERVICE DOORS. REFER ELEVATIONS FOR HEIGHT. FURNISHED BY OWNER, INSTALLED BY GC
L66EM		EXTERIOR RECESS EMERGENCY LIGHT			ELITE HOUSING: LD6C-AT LED MODULE: ELITE LED LIGHTING WET LOCATION: RL607-14W-120-FL-30K-SN-SN-WET LOCATION	EMERGENCY RECESSED DOWN LIGHT - NORMALLY ON INVERTER UNIT - ISOLITE, IMI-12-LC-V1 FURNISHED BY OWNER INSTALLED BY GC
L90		DECORATIVE LED WALL SCONCE			HINKLEY LIGHTING, ATLANTIS: BRONZE; 1649BZ-LED	AT PORTAL OF ENTRY DOOR. REFER ELEVATIONS FOR HEIGHT FURNISHED BY OWNER, INSTALLED BY GC
L97		LED MOTION SECURITY FLOODLIGHT			LITHONIA LIGHTING OLF 2RH 40K 120V MO BZ	INTERIOR LIGHT SENSOR TO BE WALL MOUNTED AT +142" FURNISHED BY OWNER, INSTALLED BY GC
L91		DECORATIVE LED WALL SCONCE			HINKLEY LIGHTING, KORE: BRONZE; 1872BZ-LED	ALONG REAR EIFS BAND FURNISHED BY OWNER, INSTALLED BY GC

## CEILING SCHEDULE

INSTALLED AND FURNISHED BY G.C. UNLESS NOTED OTHERWISE

NO	MANUFACTURER	DESCRIPTION	MATERIAL	FINISH
C1	ARMSTRONG	2' X 2' SUSPENDED T-BAR GRID CEILING SYSTEM	CUSTOM #PN91311	T-BAR AND GRID COLOR: SEPIA CONTACT AT ARMSTRONG-SHERRY BRUNT 1-800-442-4212
C2	USG	2' X 4' SUSPENDED T-BAR GRID CEILING SYSTEM	"VINYL ROCK" VINYL CLAD GYP. BD PANELS	SMOOTH AND WASHABLE WHITE
C3	GOLD BOND	MONOLITHIC CEILING ON METAL FRAMING	5/8" GYP. BD.	SMOOTH PAINT - WHITE AND WASHABLE
C4	USG	2' X 2' SUSPENDED T-BAR GRID CEILING SYSTEM	"VINYL ROCK" VINYL CLAD GYP. BD PANELS	PAINT GRID AND TILES AS SHOWN ON DETAILS

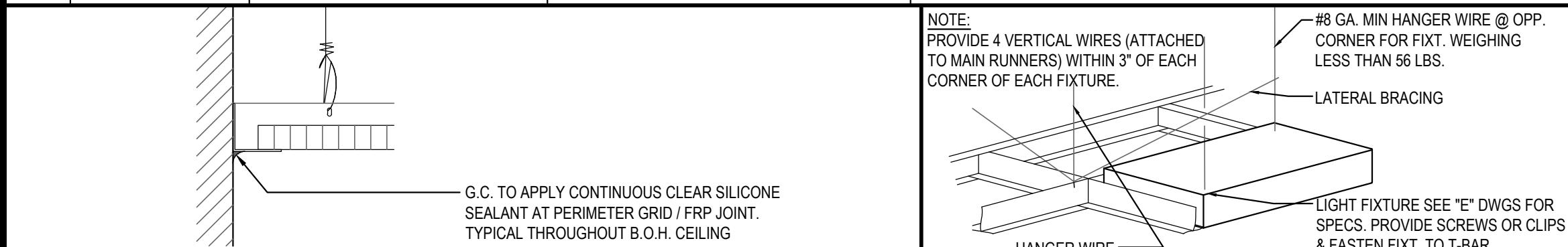

## CEILING GRID DETAIL

3

## LIGHT FIXTURE DETAIL

2

Scale= NTS

A-105

Scale= NTS

A-105

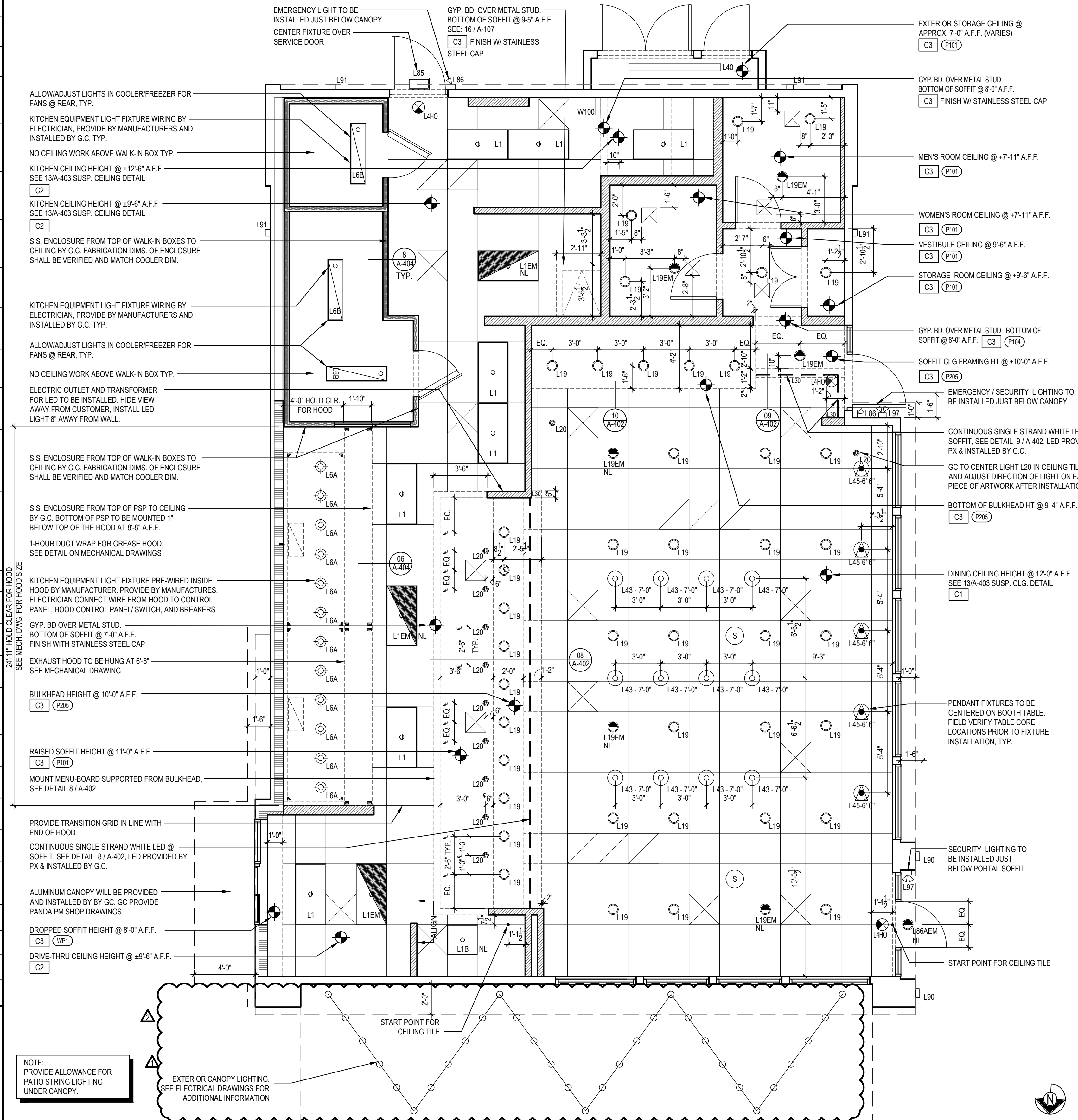

## REFLECTED CEILING PLAN

1

Scale= 1/4" = 1'-0"

A-105



PANDA RESTAURANT GROUP INC.

1683 Walnut Grove Ave.  
Rosemead, California  
91770

Telephone: 626.799.9898  
Facsimile: 626.372.8288

All ideas, designs, arrangement and plans indicated or represented by this drawing are the property of Panda Express Inc. and were created for use on this specific project. None of these ideas, designs, arrangements or plans may be used by or disclosed to any person, firm, or corporation without the written permission of Panda Express Inc.

## REVISIONS:

- 1 06.04.21 ISSUE FOR BID
- 2 06.08.21 BID ADDENDUM

## ISSUE DATE:

- 1 04.29.2021 ISSUE FOR PERMIT
- 2 06.04.2021 ISSUE FOR BID

DRAWN BY:

JDV

PANDA PROJECT #: - S8-22-D8135

C&P PROJECT #: - 2200775



06.04.2021

## PANDA EXPRESS

TRUE WARM AND WELCOME 2300  
SKYBROOKE BOULEVARD & STATE ROAD 54  
LUTZ, FL 33558

A-105

REFLECTED CEILING PLAN

TRUE WARM & WELCOME 2300 R4