

BK 39 Pg 5

CORNER RECORD

Document Number CR 4371

City of BERKELEY County of ALAMEDA, California

Brief Legal Description CITY MONUMENT B 0124

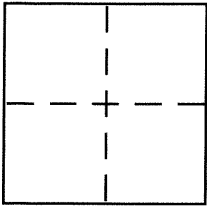

CORNER TYPE

Government Corner ☐ Control ☒
 Meander ☐ Property ☐
 Rancho ☐ Other ☐
 Date of Survey 5-3-2010

COORDINATES (Optional)

N. _____
 E. _____
 Zone _____ NAD27 ☐ NAD83 ☐
 NAD83 Epoch _____
 Elev. _____
 Vert. Datum: NGVD29 ☐ NAVD88 ☐
 Meas. Units: Metric ☐ Imperial ☐

Corner – Left as found ☒ Found and tagged ☐ Established ☐ Reestablished ☐ Rebuilt ☐

Identification and type of corner found: Evidence used to identify or procedure used to establish or reestablish the corner:

FOUND CITY MONUMENT

In compliance with Section 8771 of the Professional Land Surveyors' Act, this corner record is being filed to ESTABLISH the position of an existing monument PRIOR to street or highway construction.

A description of the physical condition of the monument as found and as set or reset: _____

SET CROSS

SURVEYOR'S STATEMENT

This Corner Record was prepared by me or under my direction in conformance with

the Land Surveyor's Act on MAY 7, 2010

Signed Robert J. Brunel P.L.S. or R.C.E. No. 4961

COUNTY SURVEYOR'S STATEMENT

This Corner Record was received 12-10-2010

and examined and filed 1-10-2011

Signed Russell R. Penland, Jr. P.L.S. or R.C.E. No. 5726

Title COUNTY SURVEYOR

County Surveyor's Comment _____

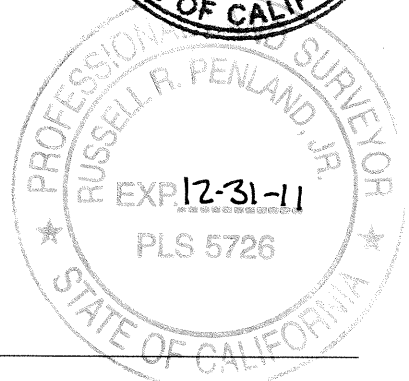

CF32Q7

DEAKIN ST.

FOUND 1/4" BRASS PIN MONUMENT
IN CONCRETE INSIDE STANDARD CASTING
AT ASHBY AVENUE AND ELLSWORTH STREET
#B0124 ELEVATION=178.02

ELLSWORTH ST.
ELEVATION=180.00

ASHBY AVENUE (80' WIDE)

FOUND 1/4" BRASS PIN MONUMENT
IN CONCRETE INSIDE STANDARD CASTING
AT ASHBY AVENUE AND DEAKIN STREET
#B0123

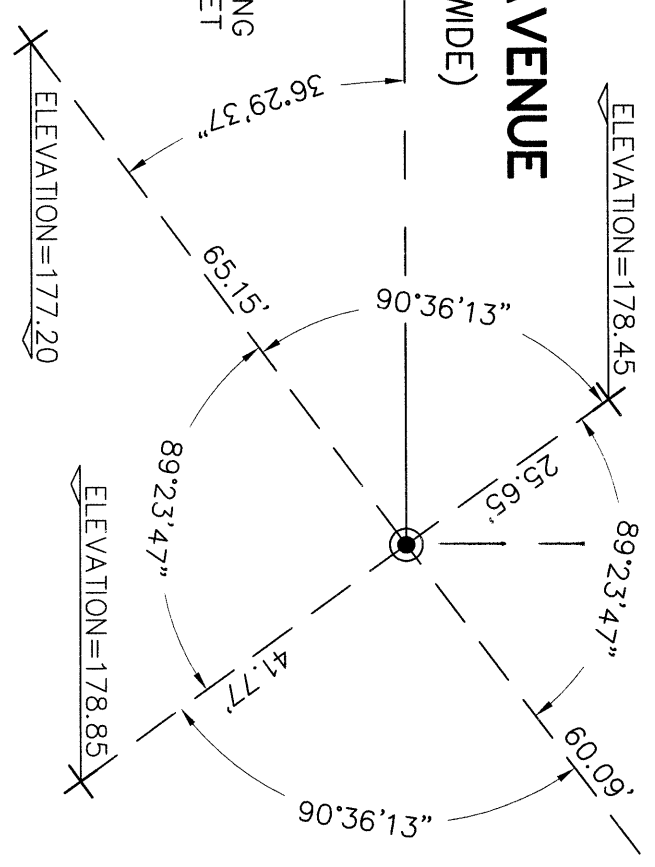

LEGEND

- FOUND CITY MONUMENT AS NOTED
- + SET CROSS

CORNER RECORD

TO REFERENCE THE MONUMENT
AT ASHBY AVENUE AND ELLSWORTH STREET
CITY OF BERKELEY, COUNTY OF ALAMEDA, CALIFORNIA

MAY 3, 2010 SCALE: 1"=20'