

EXHAUST FAN INFORMATION – JOB#4438143

FAN UNIT NO	TAG	QTY	FAN UNIT MODEL #	MANUFACTURER	CFM	ESP	RPM	MOTOR ENCL	HP	BHP	PHASE	VOLT	FLA	DISCHARGE VELOCITY	WEIGHT (LBS)	SONES
1		1	EABDU18	ECDN-AJR	3450	1.250	1223	DDP	2.000	1.3860	3	208	5.9	797 FPM	189	17.6
2		1	EABDU18	ECDN-AJR	3450	1.250	1223	DDP	2.000	1.3860	3	208	5.9	797 FPM	189	17.6
3		1	EABDCR7	ECDN-AJR	450	0.250	1128	DDP	0.250	0.0850	1	115	4.8		90	6.3

CONDENSER DETAILS

FAN UNIT NO	TAG	FAN UNIT MODEL #	CONDENSER NO	TONNAGE	VOLTAGE	PHASE	FREQUENCY	MCA	RLA	MAX FUSE SIZE	MIN WIRE SIZE	SEER
4		EA3-D500-G18-MPU	1	5	208-230	3 PHASE	60 HZ	21.4 AMPS	17.4 AMPS	30 AMPS	10 AWG	14
			2	5	208-230	3 PHASE	60 HZ	21.4 AMPS	17.4 AMPS	30 AMPS	10 AWG	14

MUA FAN INFORMATION – JOB#4438143

FAN UNIT NO	TAG	QTY	FAN UNIT MODEL #	BLOWER	HOUSING	MIN CFM	DESIGN CFM	ESP	RPM	MOTOR ENCL	HP	BHP	PHASE	VOLT	FLA	MCA	MDCP	WEIGHT (LBS)	SONES
4		1	EA3-D500-G18-MPU	G18-PB	A3-D500	3500	5520	0.750	922	DDP,PREMIUM	5.000	3.7620	3	208	15.0	18.8A	30A	1912	17.7

COILS – JOB#4438143

FAN UNIT NO	TAG	COIL TYPE	DESIGN CFM	COOLING										HEATING									
				ENTERING DB TEMP	ENTERING WB TEMP	LEAVING DB TEMP	LEAVING WB TEMP	ENTERING FLUID TEMP	LEAVING FLUID TEMP	FLUID FLOW RATE	PERCENT GLYCOL	TOTAL CAPACITY	SENSIBLE CAPACITY	LATENT CAPACITY	ENTERING DB TEMP	LEAVING DB TEMP	ENTERING FLUID TEMP	LEAVING FLUID TEMP	FLUID FLOW RATE	PERCENT GLYCOL	STEAM PRESSURE	TOTAL CAPACITY	SENSIBLE CAPACITY
4		DX	5520	95.0°F	78.0°F	83.3°F	72.6°F	---	---	---	---	120.0 MBH	67.7 MBH	52.3 MBH	---	---	---	---	---	---	---	---	---

GAS FIRED MAKE-UP AIR UNIT(S)

FAN UNIT NO	TAG	INPUT BTUS	OUTPUT BTUS	TEMP RISE	REQUIRED INPUT GAS PRESSURE	GAS TYPE	BURNER EFFICIENCY(%)
4		409003	376283	65°F	7 IN. W.C. – 14 IN. W.C.	NATURAL	92

FAN OPTIONS

FAN UNIT NO	TAG	QTY	DESCRIPTION
1		1	GREASE BOX.
		1	UPBLAST FAN WHEEL ACCESS PORT.
		1	FAN BASE CERAMIC SEAL – INSTALLED AT PLANT – FOR GREASE DUCTS.
2		1	2 YEAR PARTS WARRANTY.
		1	GREASE BOX.
		1	UPBLAST FAN WHEEL ACCESS PORT.
3		1	FAN BASE CERAMIC SEAL – INSTALLED AT PLANT – FOR GREASE DUCTS.
		1	2 YEAR PARTS WARRANTY.
		1	I 15-BDD DAMPER.
4		1	2 YEAR PARTS WARRANTY.
		1	AC INTERLOCK RELAY – 24VAC COIL.
		1	LDW FIRE START.
		1	INLET PRESSURE GAUGE, 0-35".
		1	MANIFOLD PRESSURE GAUGE, -5 TO 15" WC.
		1	MOTORIZED BACKDRAFT DAMPER FOR A3-D HOUSING. MEETS AMCA CLASS 1A RATING.
		1	COOLING THERMOSTAT AND RELAY (NOT REQ FOR EVAP).
		1	DOWNTURN PLENUM FOR SIZE 3 DX COIL MODULE.
		1	SHIP CONDENSERS LOOSE. TWO CONDENSERS, THREE PHASE. CONDENSER DISCONNECTS SHIPPED LOOSE.
		1	FREEZESTAT (10).
		1	10 TON 2 CIRCUIT (5/5) MODULAR PACKAGED COOLING OPTION FOR SIZE 3 DF/EH MUA (3,600 TO 6,000 CFM), 208V/230V, 3 PHASE. COOLING THERMOSTAT OR PROGRAMMABLE STAT REQUIRED FOR PROPER OPERATION.
		1	SEPARATE 120V WIRING PACKAGE (REQUIRED AND USED ONLY FOR DCV OR PREWIRE WITH VFD) – THREE PHASE ONLY.
		1	2 YEAR PARTS WARRANTY.

FAN ACCESSORIES

FAN UNIT NO	TAG	EXHAUST			SUPPLY		
		GREASE CUP	GRAVITY DAMPER	WALL MOUNT	SIDE DISCHARGE	GRAVITY DAMPER	MOTORIZED DAMPER
1		YES					
2		YES					
3			YES				
4						YES	

CURB ASSEMBLIES

NO	ON FAN	WEIGHT	ITEM	SIZE
1	# 1	34 LBS	CURB	26.500"W X 26.500"L X 30.000"H VENTED HINGED.
2	# 2	34 LBS	CURB	26.500"W X 26.500"L X 30.000"H VENTED HINGED.
3	# 3	19 LBS	CURB	19.500"W X 19.500"L X 12.000"H
4	# 4	114 LBS	RAIL	6.000"W X 35.000"L X 20.000"H.
4	# 4	114 LBS	CURB	35.000"W X 84.000"L X 20.000"H INSULATED.

FANS #1, #2 – EABDU18 EXHAUST FAN

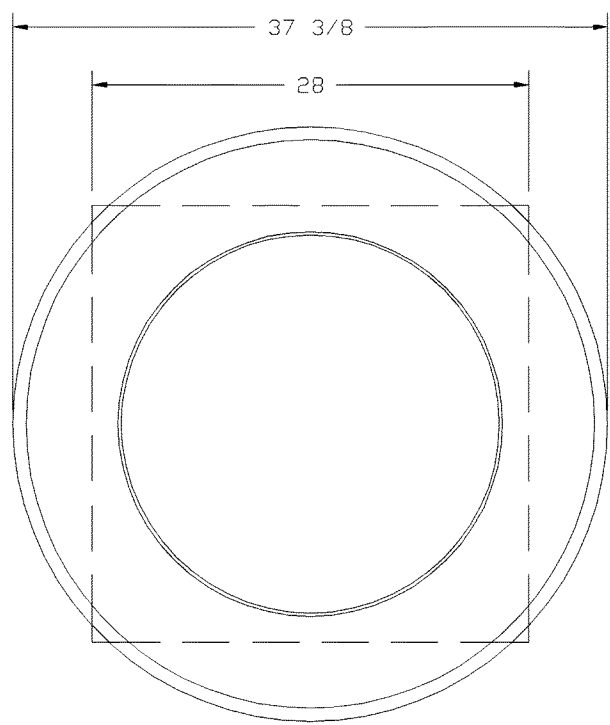
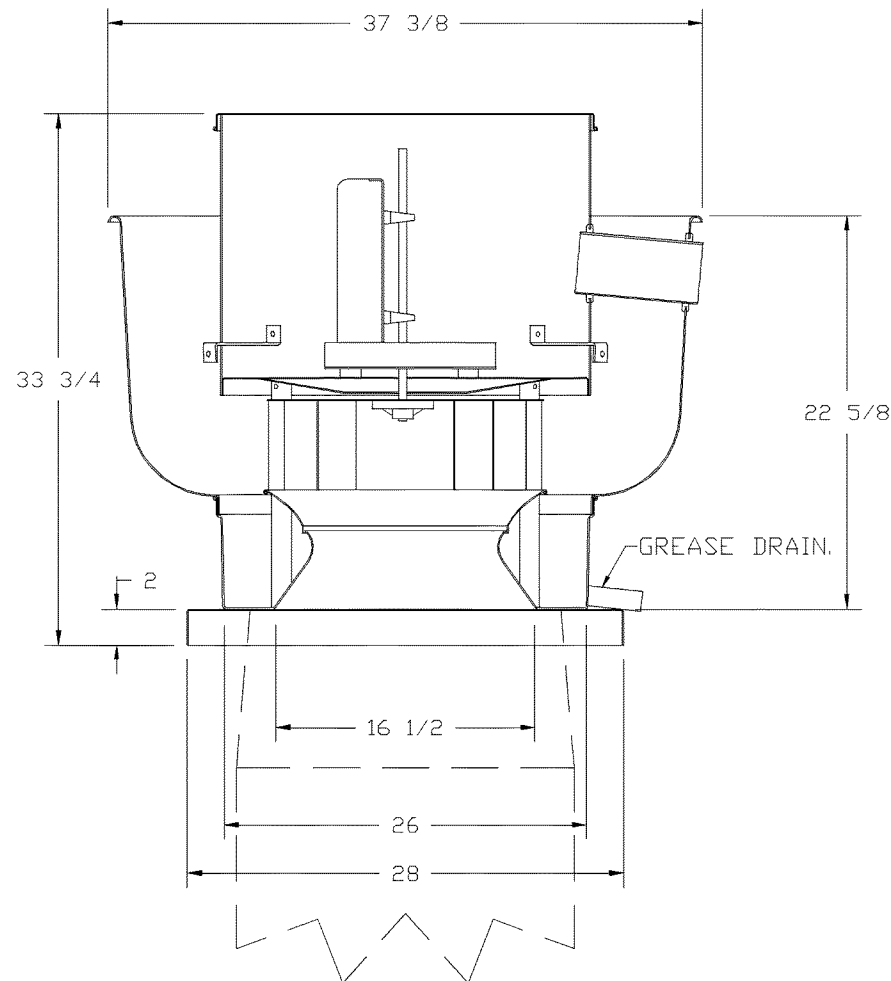

TOP VIEW

FEATURES:

- ROOF MOUNTED FANS.
- RESTAURANT MODEL.
- UL705 AND UL762 AND ULC-S645.
- AMCA SOUND AND AIR CERTIFIED.
- WIRING FROM MOTOR TO DISCONNECT SWITCH.
- NEMA 3R SAFETY DISCONNECT SWITCH.
- HIGH HEAT OPERATION 360°F (149°C).
- GREASE CLASSIFICATION TESTING.

NORMAL TEMPERATURE TEST
EXHAUST FAN MUST OPERATE CONTINUOUSLY WHILE EXHAUSTING AIR AT 300°F (149°C) UNTIL ALL FAN PARTS HAVE REACHED THERMAL EQUILIBRIUM, AND WITHOUT ANY DETRIMENTARY EFFECTS TO THE FAN WHICH WOULD CAUSE UNSAFE OPERATION.

ABNORMAL FLARE-UP TEST
EXHAUST FAN MUST OPERATE CONTINUOUSLY WHILE EXHAUSTING BURNING GREASE VAPORS AT 600°F (316°C) FOR A PERIOD OF 15 MINUTES WITHOUT THE FAN BECOMING DAMAGED TO ANY EXTENT THAT COULD CAUSE AN UNSAFE CONDITION.

OPTIONS

GREASE BOX.
UPBLAST FAN WHEEL ACCESS PORT.
FAN BASE CERAMIC SEAL – INSTALLED AT PLANT – FOR GREASE DUCTS.
2 YEAR PARTS WARRANTY.

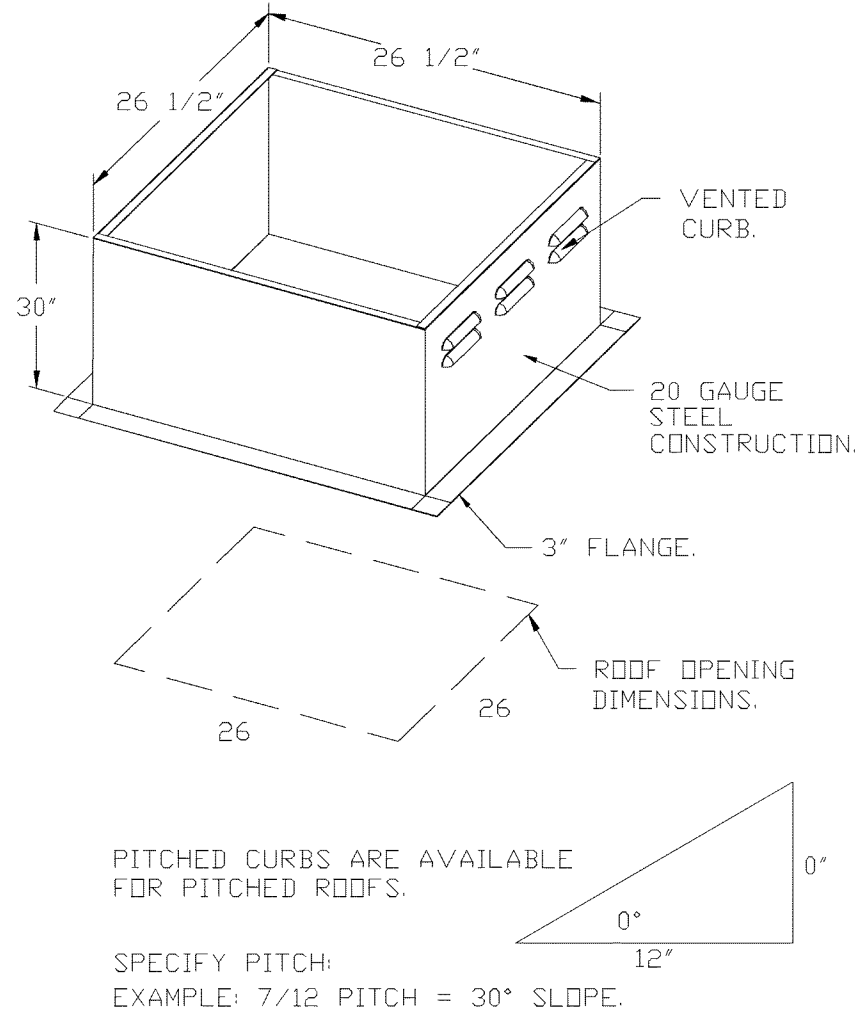

PITCHED CURBS ARE AVAILABLE FOR PITCHED ROOFS.

SPECIFY PITCH:
EXAMPLE: 7/12 PITCH = 30° SLOPE.

NOTE: UNLESS OTHERWISE STATED, PANDA RESTAURANT GROUP SHALL PROVIDE ALL EQUIPMENT ON THE FOLLOWING CAPTIVEAIRE SHEETS, INCLUDING: HODDS, FIRE SYTEM, EXHAUST FANS, SUPPLY FAN, BATHROOM FAN AND ELECTRICAL INTERLOCK PACKAGE

DOUBLE WALL DUCT BY MECHANICAL PLEASE USE CONTACT BELOW FOR PRICING

ANSUL GAS VALVE:

THE ANSUL GAS VALVE IS PROVIDED BY CAPTIVEAIRE SYSTEMS. CONTACT OUR OFFICE WITH THE VALVE SIZE 3 DAYS IN ADVANCE OF WHEN IT IS NEEDED ON SITE.

FOR QUESTIONS CALL THE
CAPTIVEAIRE
SOUTHERN CALIFORNIA OFFICE

3002 DDW AVENUE, SUITE 410
TUSTIN, CA 92780
TEL: 714-957-1500 EMAIL: REG66@CAPTIVEAIRE.COM

REVISIONS	
DESCRIPTION	DATE



www.captiveaire.com

Southern California Office

3002 Dow Ave., Suite 410, Tustin, CA 92780 PHONE: (714) 957-1500 FAX: (919) 227-5975 EMAIL: reg66@captiveaire.com

PX - 236 - ACPSP - HEAT DX - EXTREME COLD - R2

DATE: 2/25/2021

DWG.#:
4438143

DRAWN BY: AH-86

SCALE:
3/4" = 1'-0"

MASTER DRAWING

SHEET NO.
4



PANDA EXPRESS, INC.
1683 Walnut Grove Ave.
Rosemead, California
91770

Telephone: 626.799.9898
Facsimile: 626.372.8288

All ideas, designs, arrangement and plans indicated or represented by this drawing are the property of Panda Express Inc. and were created for use on this specific project. None of these ideas, designs, arrangements or plans may be used by or disclosed to any person, firm, or corporation without the written permission of Panda Express Inc.

REVISIONS:

ISSUE DATE:

04/27/21 WALMART REVIEW
05/05/21 ISSUE FOR PERMIT

DRAWN BY:

PANDA PROJECT #: S8-22-D8044

PANDA STORE #: D8044

ARCH PROJECT #: Q511070001

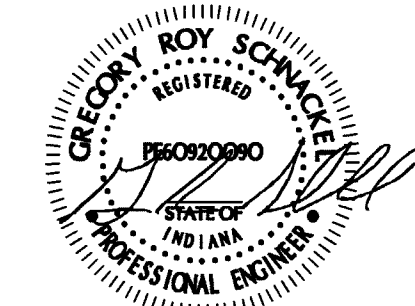

Date: 05/05/21

05-05-21

FOR INFORMATION ONLY
Schnackel
engineers,
New York • Omaha • Los Angeles • Seattle • Honolulu
800-581-0963 www.schnackel.com
SEE JOB SPECIFICATIONS

PANDA EXPRESS

TRUE WARM & WELCOME
STATE ST. & NEW RD.
GREENFIELD, IN 46140

M-403

HOOD DETAIL PLAN

TRUE WARM & WELCOME 2300 R5